

# WOODINVILLE WATER DISTRICT PRIVATE SIDE SEWER ASBUILT REQUIREMENTS

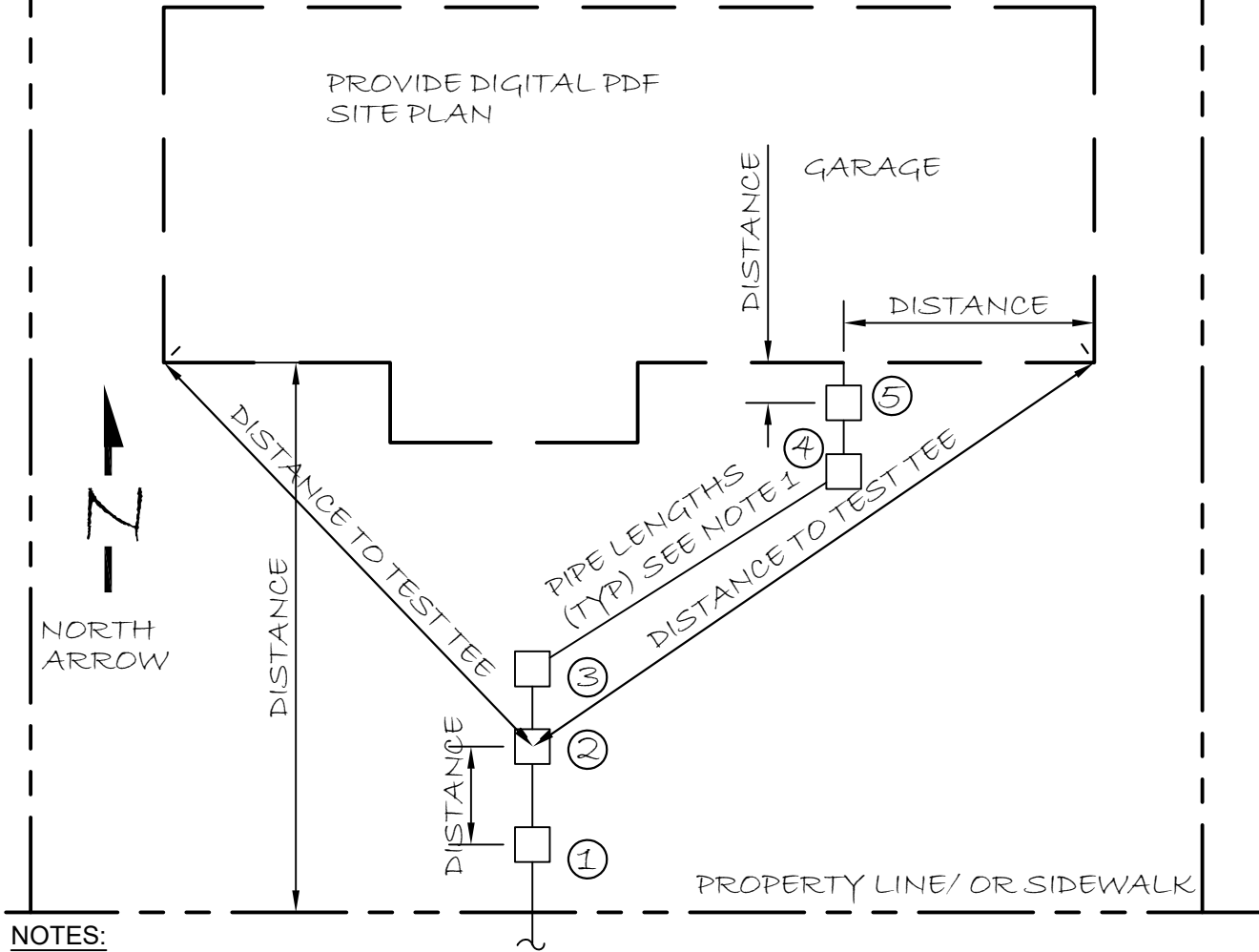

**NOTES:**

1. PROVIDE ALL PIPE LENGTHS - MEASURE CENTER TO CENTER ON FITTINGS.
2. LIST FITTINGS OR FITTING CLUSTERS STARTING AT THE DISTRICT CLEANOUT. PROVIDE DEPTHS AT THE TEST TEE AND PRIVATE CLEANOUT. EXAMPLE BELOW.
3. PROVIDE PDF SITE PLAN SHOWING STRUCTURE TO BE BUILT.

- |   |  |
|---|--|
| <ul style="list-style-type: none"> <li>①</li> <li>②</li> <li>③</li> <li>④</li> <li>⑤</li> </ul> | <p>6" DISTRICT CLEANOUT</p> <p>6"x4" REDUCER<br/>4" TEST TEE, 6' DEEP</p> <p>4"x45° BEND</p> <p>4"x45° BEND</p> <p>4" WYE (VERT) 3' DEEP, 4" CLEANOUT 18" DEEP</p> |
|---|--|

**EXAMPLE**

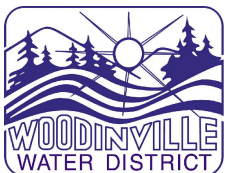

**Woodinville  
Water District**

**PRIVATE SIDE SEWER  
ASBUILT REQUIREMENTS**



**SEWER STD.  
PLAN NO. 25**

REVISION DATE  
10-18